

Instructions for Mounting the Burris FastFire™ or FastFire II™ Sight on a Winchester® Model 94

If you have an Angle Eject model or other pre-tapped receiver, proceed with the instructions below. If your receiver is not drilled and tapped, that will need to be done first. You are responsible



for the drill & tap operation. Guidelines for this are also enclosed in this package. We suggest you have it done by a competent gunsmith.

Install the Mount

Put a drop or two of thread lock compound (Loctite R or similar) in the appropriate holes at the top rear of the receiver. Place the Sight Mounting Base on the rear of the receiver so that the holes in the base line up with the ones in the receiver. Install the provided Cap Screws into the holes and tighten them.

If Installing the Original FastFire

If you are mounting an original FastFire (shown above) mount the FastFire to the base with a provided Lock Washer and Flat Head Screw in each of the holes. Don't forget to install the battery. **Also, don't use thread lock as these screws require removal to change batteries.**

If Installing the Waterproof FastFire II

If you are mounting a new sealed FastFire II, place the metal-backed gasket from the FastFire II package on to the base with the rubber up and so that the holes line up. Mount the FastFire II on top of the gasket and to the base with a provided and Flat Head Screw only (do not use lock washers) in each of the holes. Don't forget to install the battery. **Also, don't use thread lock as these screws require removal to change batteries.** The FastFire II may also be used without the gasket (although the unit will not be fully waterproof).



Install the Sight Rim Pad

You will next need to install one of the pads included with the mount on the front top edge of the hood over the sight lens (as shown in the picture). The pad protects the sight from damage caused by empties during ejection. Clean any oil or other debris off the sight hood. (Acetone works great, and for cleaning the lens) Avoid touching the sticky side of the pad. Three pads are included.

Sight-In

We suggest you rough sight-in the unit by turning on the sight on and using the instructions included with the FastFire to make the dot appear where the rifle's iron sights are pointing. Most people will want to remove the hood from over the front sight. It slides off easily. You will definitely want to final Zero the FastFire at the range again using the instructions included in the FastFire package. (Don't forget to loosen lock the Lock

Screws at the rear of the unit before adjustments are made and re-tighten after.)

Supplemental

Over the years there have been lots of discussions about the correct sight-in distance for lever guns using various ammo. There has also been some re-thinking lately about distances for use with the new "Lever-Revolution" ammo. A little research may go a long way.

Also, the FastFire has virtually zero parallax. That means no matter where in the lens the dot appears to you, the Dot is where the shot is going (at your zero range). Just get the Dot on the target, don't worry about where in the lens it is. This makes the FastFire very fast in the brush and on running game.

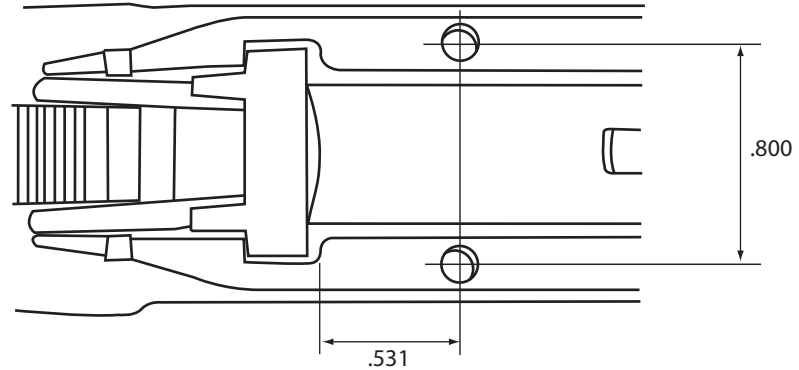

Model 94 Drill & Tap

You will be responsible for the drill & tap operation. We suggest you have it done by a competent gunsmith.

#31 Tap drill (.120Dia.) .175 Max. Deep. Do not break through.
#6-48 Tap .150 Min. Full Thread Depth.

(Taps: Brownells Plug Tap
395-648-102 & Bottoming Tap
395-648-103)

 **BURRIS**[®]

(970) 356-1670

www.burristactical.com